



---

## LUXAFLEX® ROLLER BLIND XL

A high quality and durable roller blinds system, developed to fit large windows. The blinds are made to measure and available in six different models. Coupled blinds can be made, with up to three blinds on one operation. Great fabric collection to choose from; screen for view through and heat regulation, opaque qualities for privacy and black out/dim out qualities that blocks light.



# TECHNICAL INFORMATION

Models	6
Max width	3600 mm
Max height	4000 mm
Max surface	12 sqm

All measures are depending on what fabric is chosen.

## General

Extruded strong aluminium tubes in two different dimensions; 37 or 50 mm. Fabric is attached with spline, which gives possibility to change fabric.

## Mounting

All models are possible to mount on wall or in ceiling. XL-10 side brackets are also possible to mount at the side. All models can be made with wire guiding that helps the blind to stay at place.

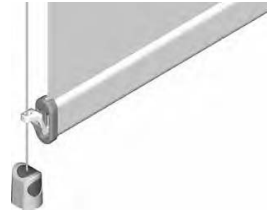

## Finishing options of the blind



Welded channel with covered bottom weight (standard)



Finishing Oval 124



Finishing Stadium 600



## Operation

- Chain: white, black or grey operation. Plastic chain is standard, steel is optional.
- Crank: in steel, fixed or detachable. Length 1800 mm as standard or special length up to 4300 mm.
- 230V AC Motor and PowerView®: integrated in the tube, suitable with different control systems like radio, KNX, IB or wired solutions.



Chain operation

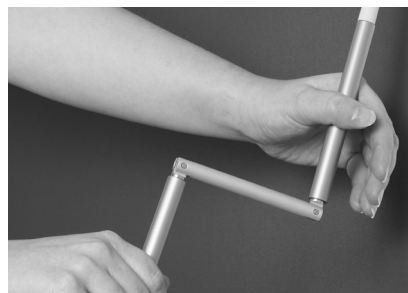

Crank operation



## Models/Sketches

**XL-10 Bracket**, classic roller blind with coloured steel brackets on the side, plastic cover endcaps. ○ ● ●

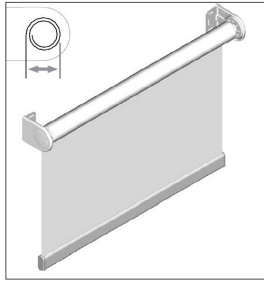

RAL-codes for metal parts: white 9016, black 9005, grey 9006

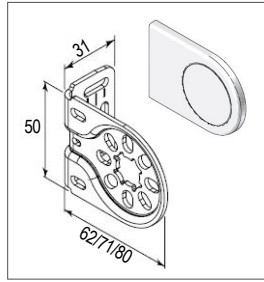

Bracket/plastic cover endcap

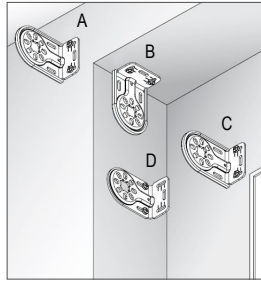

A: on face wall mount, B: ceiling mount, C: on the frame, D: in recess, side mount

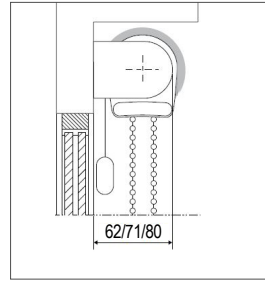

Bracket 38/46/55 mm distance. Note: the roll and operation will build outside the measures.

**XL-20 Mounting profile**, quick and easy mounting of the roller blind. ○ ● ●

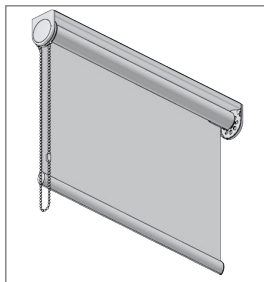

RAL-codes for metal parts: white 9016, black 9005, grey 9006

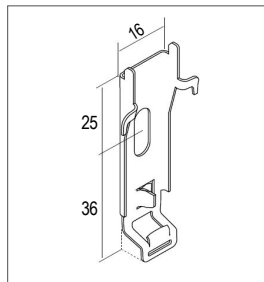

Bracket

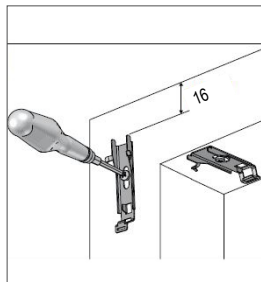

Mounting of brackets

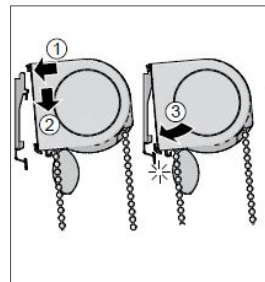

Mounting of the profile

**XL-40 Cover profile**, discrete roller blind with cover profile on front and sides. ○

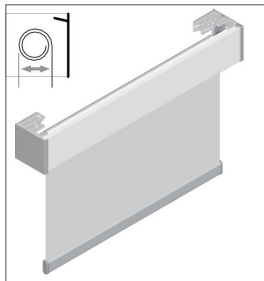

RAL-code for metal parts: white 9016

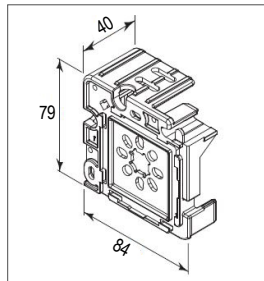

Bracket

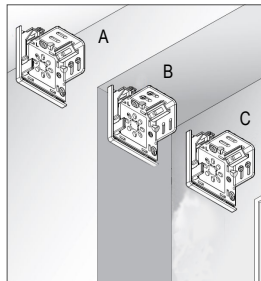

A: on face wall mount, B: ceiling mount, C: on the frame

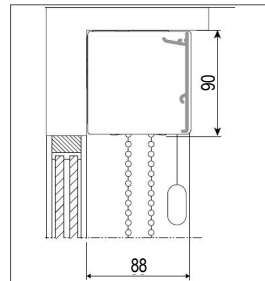

Valance dimension incl. brackets

**XL-S3 Cassette open**, for protection of the fabric roll and nicer look. ○ ● ●



RAL-codes for metal parts: white 9016, black 9005, grey 9006

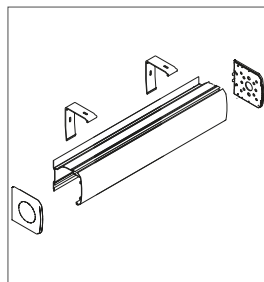

Cassette

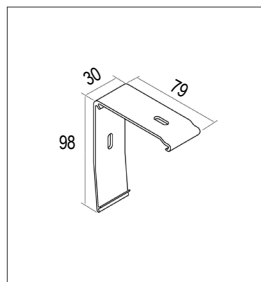

Bracket

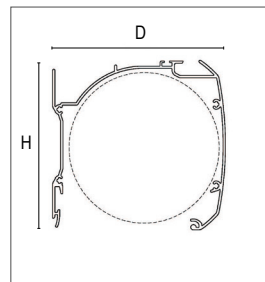

Cassette dimension incl. brackets: H=102, D=99

**Models/Sketches cont.**

**XL-150 Combi**, two blinds in one bracket, e.g. black out fabric at the back and transparent screen fabric at the front, all covered with a cover profile.

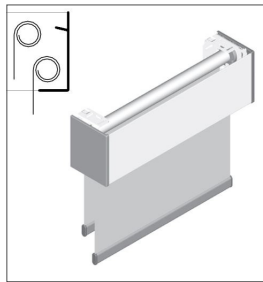

RAL-code for metal parts: white 9016

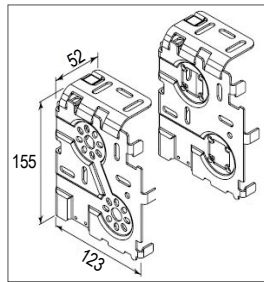

Bracket operation side/  
Bracket non-operation side

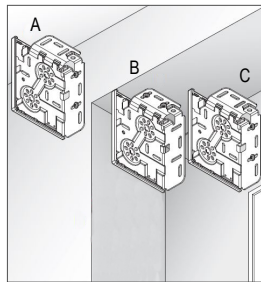

A: on face wall mount, B: ceiling  
mount, C: on the frame

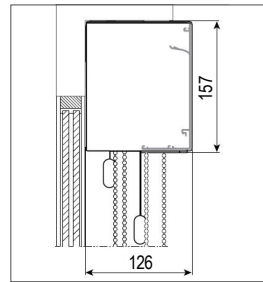

Valance dimension incl. brackets

**XL-110 Cassette**, for room darkening with optional side channels with brush and bottom profile.

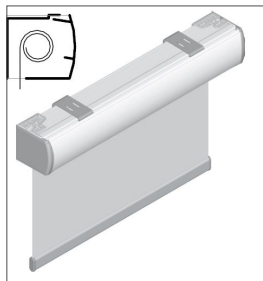

RAL-codes for metal parts: white 9016

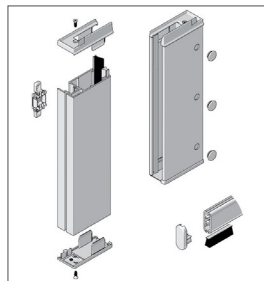

Side channel W: 64, D: 28 mm

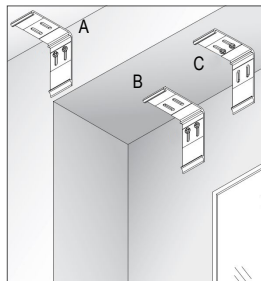

A: on face wall mount, B: on the  
frame, C: ceiling mount.  
Bracket, mm = H: 83, W: 40, D: 78

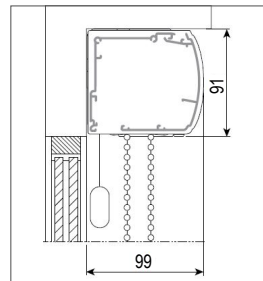

Cassette dimension incl. brackets

---

# GLARE & REFLECTION CONTROL

## Fabrics

Multiple fabrics with different functions and designs for every room.

- Room darkening, for rooms that is in need of light block.
- Opaque fabrics, for privacy and sun protection.
- Screen fabric, for nice view through, heat regulation and to prevent glare.

Examples:

**Verosol EnviroScreen**, 2% openness factor. Screen fabric with aluminium back side that reflects 74% of solar energy. Environmentally certified.

**Verosol SilverScreen**, 2% or 4 % openness factor. Screen fabric with aluminium back side that reflects up to 85% of solar energy.

See collection book or [Luxaflexproject.se](http://Luxaflexproject.se) for more information and technical specification.



Verosol SilverScreen

---

# CONTACT US

## Showrooms in Sweden

Our two showrooms are located in Stockholm and Gothenburg. Please see below the contact persons for each location.

### Etage 1 Stockholm

Rosenlundsgatan 40  
[www.etage1.se](http://www.etage1.se)

Contact: Calle Kihlman  
+46 (0)739-44 14 67  
[calle.kihlman@luxaflex.se](mailto:calle.kihlman@luxaflex.se)

### Studio L6 Göteborg

Lasarettsgatan 6  
[www.studiol6.se](http://www.studiol6.se)

Contact: Pernilla Norberg  
+46 (0)708-16 62 91  
[pernilla.norberg@luxaflex.se](mailto:pernilla.norberg@luxaflex.se)

Our customer service in each country are more than happy to help you with any product question:

### Sweden

Phone: +46 (0)371-895 00  
E-mail: [projektoffert@luxaflex.se](mailto:projektoffert@luxaflex.se)  
[www.luxaflexproject.se](http://www.luxaflexproject.se)

### Denmark

Phone: +45 86 17 93 77  
E-mail: [projekt@luxaflex.dk](mailto:projekt@luxaflex.dk)  
[www.luxaflexproject.dk](http://www.luxaflexproject.dk)

### Norway

Phone: +47 23 17 33 00  
E-mail: [prosjekt@luxaflex.no](mailto:prosjekt@luxaflex.no)  
[www.luxaflexproject.no](http://www.luxaflexproject.no)

